

- Existing Lease
- Existing Master Lease Parcel
- Existing Permit
- Non-Useable Land
- Useable Land
- Operation Land
- Reserve Boundary
- ROW Boundary

Area Table (both sheets)

Operation Land = 41 ac±
 Non-Useable Land = 15 ac±
 Useable Land = 165 ac±
 ROW Land = 37 ac±
Total Land = 258 ac±

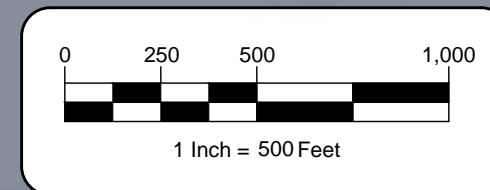

Sheet 1 of 2

ALASKA RAILROAD CORPORATION
 REAL ESTATE DEPARTMENT, LAND SERVICES
P.O. BOX 107500, ANCHORAGE, ALASKA 99510-7500

Whittier Reserve Overview

DRAWN BY: AMB	SCALE: 1" = 500'	DATE: 2019-01-22
CHECKED BY: DAS	Whittier Terminal Reserve	
APPROVED BY: DAS		

R:\00 RED\Res\WHI\WhittierReserveUpdate.dwg

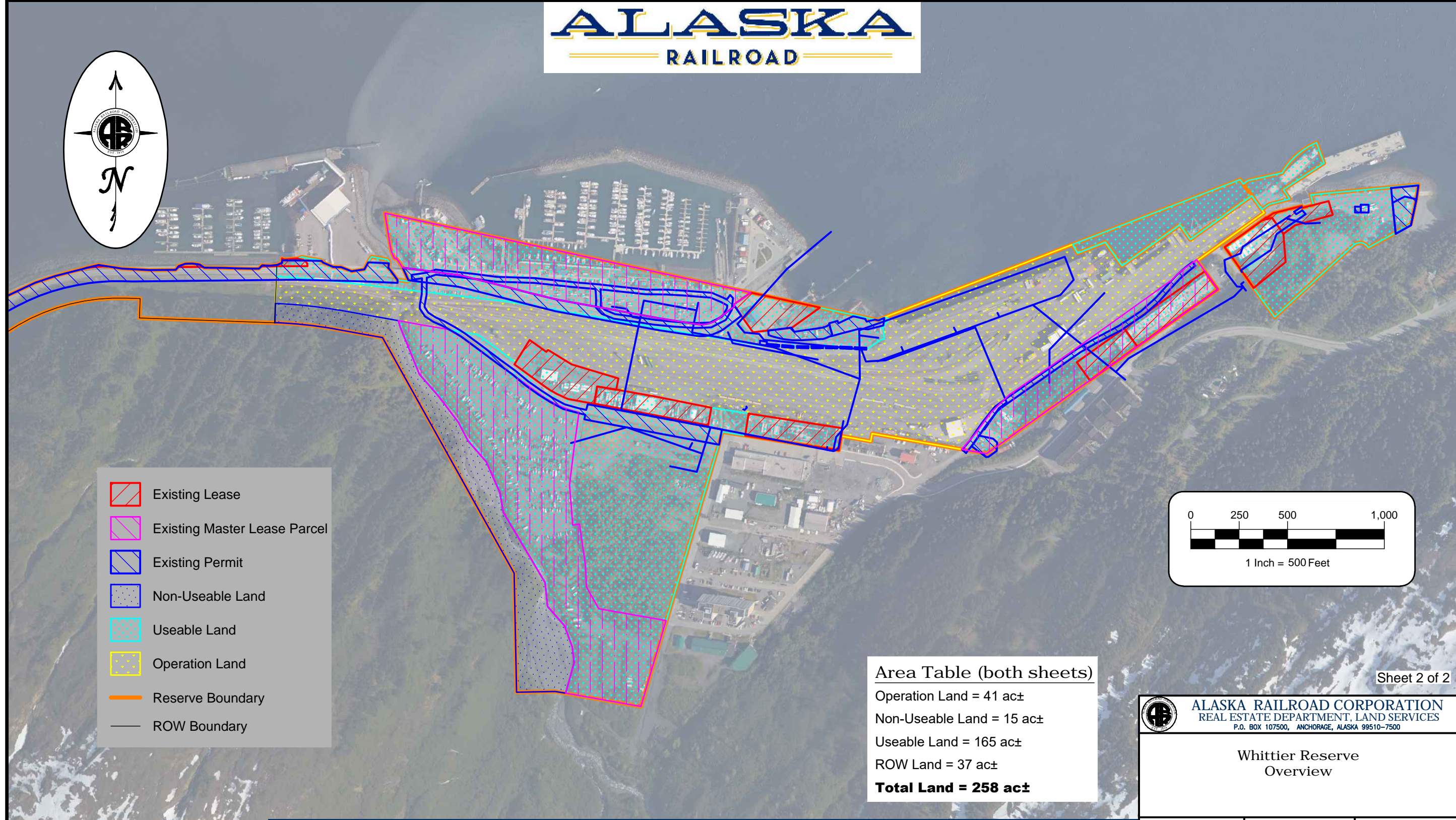
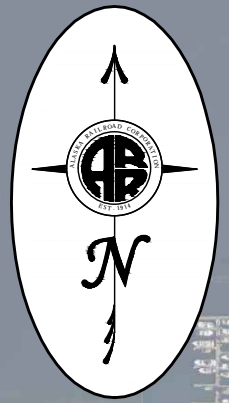

- Existing Lease
- Existing Master Lease Parcel
- Existing Permit
- Non-Useable Land
- Useable Land
- Operation Land
- Reserve Boundary
- ROW Boundary

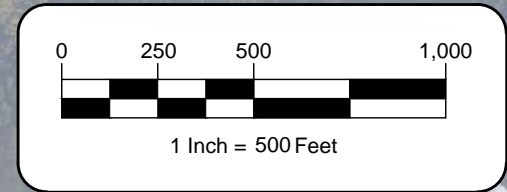

Area Table (both sheets)

Operation Land	= 41 ac±
Non-Useable Land	= 15 ac±
Useable Land	= 165 ac±
ROW Land	= 37 ac±
Total Land	= 258 ac±

Sheet 2 of 2

ALASKA RAILROAD CORPORATION
 REAL ESTATE DEPARTMENT, LAND SERVICES
P.O. BOX 107500, ANCHORAGE, ALASKA 99510-7500

**Whittier Reserve
Overview**

DRAWN BY: AMB	SCALE: 1" = 500'	DATE: 2019-01-22
CHECKED BY: DAS	Whittier Terminal Reserve	
APPROVED BY: DAS		

R:\00 RED\Res\WHI\WhittierReserveUpdate.dwg