

POINT TABLE

Pt #	Northing	Easting	Elevation	Description
100	2548352.12	1734017.13	88.91	SET 5/8" REBAR W/ YPC
102	2548421.67	1734053.21	89.01	SET PK
105	2548597.74	1733676.67	113.11	SET PK
107	2548534.60	1734117.30	88.49	SET PK
108	2548419.40	1734334.92	79.41	SET PK
110	2548104.96	1734625.06	57.56	SET PK
112	2547977.85	1735165.50	29.91	SET PK
113	2547910.69	1735435.91	37.86	SET PK
114	2547820.80	1735863.76	50.63	SET PK
115	2547701.05	1736310.48	67.68	SET PK
116	2547476.39	1736142.93	35.00	SET PK
117	2547665.05	1735865.00	34.14	SET PK
119	2547857.55	1735217.41	32.86	SET 60D NAIL
123	2548039.24	1733843.26	34.53	SET 60D NAIL
124	2548273.25	1733744.47	107.16	SET PK
126	2548170.28	1733560.36	34.20	SET PK
127	2547847.06	1734540.43	18.64	SET PK
409	2547959.42	1735189.36	39.92	FND 3.25" B/C IN BRIDGE ABUT

NOTES

- 1) HORIZONTAL DATUM AND VERTICAL DATUM IS ALASKA STATE PLANE COORDINATE SYSTEM ZONE 4, NAD83(2011), GEOID12B BASED ON OPUS PROCESSING OF CONTROL POINT 100.
- 2) IMAGERY PER OCTOBER 2019 APN UAV DATA.
- 3) CENTERLINE AND STATIONING PER ARRC CAD.
- 4) PROPERTY LINES NOT SHOWN HEREON.



SCALE: 1" = 100 FEET

LEGEND

- CONTROL POINT, SEE POINT LIST
- - - 10' CONTOURS PER 2015 MUNI LIDAR

SYM.	REVISIONS	DATE	BY



CLIENT	ALASKA RAILROAD	JOB NUMBER	19-118
PROJECT	ARRC BRIDGE 86.6	DATE	10/28/2019
SHEET TITLE	EXISTING SITE CONDITIONS	SHEET NO	1 OF 2

SCALE	1" = 100 FEET
DATE	10/28/2019
SHEET NO	1 OF 2

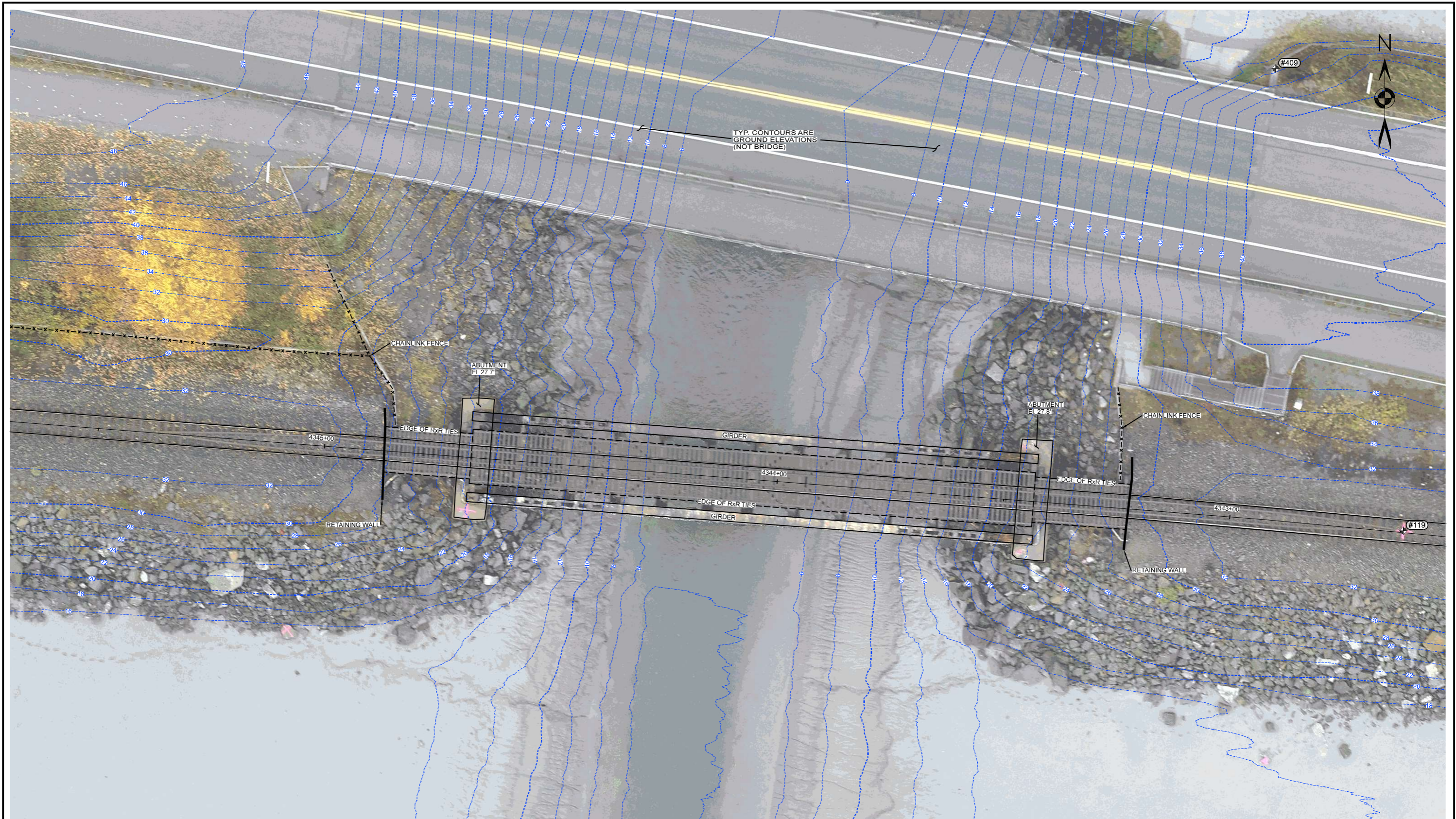

LEGEND

- CONTROL POINT, SEE POINT LIST
- 2' CONTOURS PER FILTERED 2019 APN UAV DSM



SCALE: 1" = 10 FEET

SYM.	REVISIONS	DATE	BY

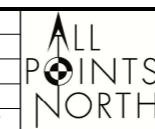

CLIENT	ALASKA RAILROAD	JOB NUMBER	19-118
PROJECT	ARRC BRIDGE 86.6		
SHEET TITLE	EXISTING SITE CONDITIONS		

SCALE	1" = 10 FEET
DATE	10/28/2019
SHEET NO	2 OF 2