



LEGEND

-  TESTHOLE
-  PENETROMETER

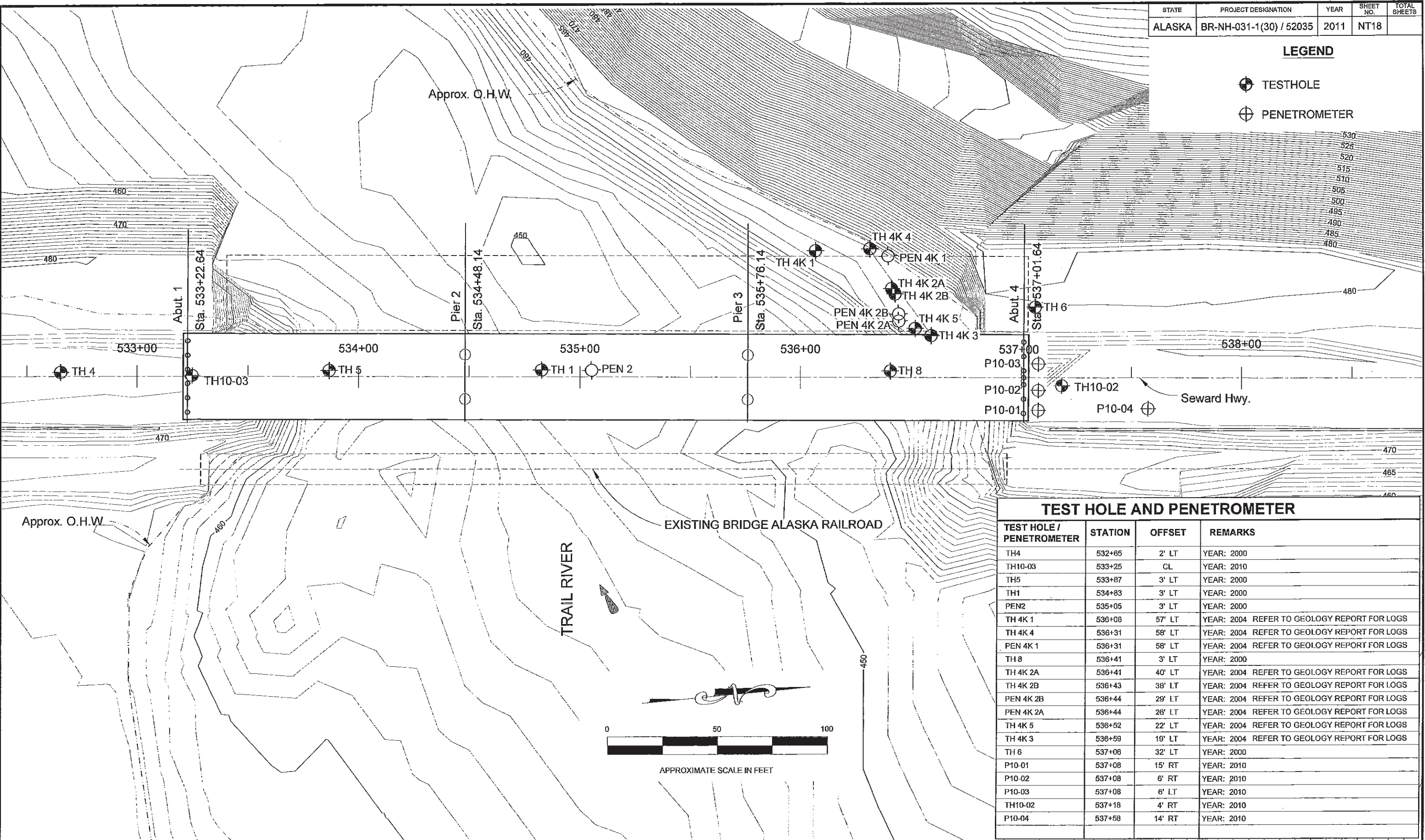

TEST HOLE AND PENETROMETER

TEST HOLE / PENETROMETER	STATION	OFFSET	REMARKS
TH4	532+65	2' LT	YEAR: 2000
TH10-03	533+25	CL	YEAR: 2010
TH5	533+87	3' LT	YEAR: 2000
TH1	534+83	3' LT	YEAR: 2000
PEN2	535+05	3' LT	YEAR: 2000
TH 4K 1	536+08	57' LT	YEAR: 2004 REFER TO GEOLOGY REPORT FOR LOGS
TH 4K 4	536+31	58' LT	YEAR: 2004 REFER TO GEOLOGY REPORT FOR LOGS
PEN 4K 1	536+31	58' LT	YEAR: 2004 REFER TO GEOLOGY REPORT FOR LOGS
TH 8	536+41	3' LT	YEAR: 2000
TH 4K 2A	536+41	40' LT	YEAR: 2004 REFER TO GEOLOGY REPORT FOR LOGS
TH 4K 2B	536+43	38' LT	YEAR: 2004 REFER TO GEOLOGY REPORT FOR LOGS
PEN 4K 2B	536+44	29' LT	YEAR: 2004 REFER TO GEOLOGY REPORT FOR LOGS
PEN 4K 2A	536+44	28' LT	YEAR: 2004 REFER TO GEOLOGY REPORT FOR LOGS
TH 4K 5	536+52	22' LT	YEAR: 2004 REFER TO GEOLOGY REPORT FOR LOGS
TH 4K 3	536+59	19' LT	YEAR: 2004 REFER TO GEOLOGY REPORT FOR LOGS
TH 6	537+08	32' LT	YEAR: 2000
P10-01	537+08	15' RT	YEAR: 2010
P10-02	537+08	6' RT	YEAR: 2010
P10-03	537+08	6' LT	YEAR: 2010
TH10-02	537+18	4' RT	YEAR: 2010
P10-04	537+58	14' RT	YEAR: 2010

DESIGNED BY: _____ CHECKED: _____ HYDRAULICS BY: _____ CHECKED BY: _____
 DRAWN BY: D.R. DODGE CHECKED: _____ FOUNDATIONS REVIEWED BY: _____
 FILE: N:\Central\STRUCT\Seward Hwy 18-25 #610 Trail R Bridge\Data\ACAD\51862_Br# 610 TH Locate 04-27-11.dwg

STATE OF ALASKA
 DEPARTMENT OF TRANSPORTATION
 AND PUBLIC FACILITIES
 STATEWIDE MATERIALS



**TRAIL RIVER BRIDGE
 SEWARD HIGHWAY
 TEST HOLE AND PENETROMETER
 LOCATIONS**

 BRIDGE No. 610
 DWG No. 18